

MAUNAWAI
mein Wasser



MAUNAWAI® Under Sink Water System

Assembly and
Instruction Manual



www.maunawai.com



TABLE OF CONTENTS

MAUNAWAI Water filter system

Technical data	4
Filter stages	4
Intervals for changing filters	4

MAUNAWAI Under Sink Water System

Parts supplied	5
Requirements for connection	6

INSTALLATION GUIDE

Preparation	6
Water connection	6
Assembling the filter case	6
Fitting the tap	7
Fitting the tubes	7
Connecting	8
Pipes and Fittings	8
Assembly	8
Water supply	9
Water discharge	9
Connecting the tap	9/10
Start	10
Disconnecting connections	10
Filter replacement	11

MAUNAWAI Water system

Congratulations on purchasing this premium product. In order to enjoy it as long as possible, please consider the following instructions:

Technical Data	Filter performance:	ca. 1,9 l/min.
	Min. pressure:	1 bar
	Temperature ranges:	room temperature– not frost-proof
	Dimensions (WxHxD):	300 x 390 x 100 mm
	Weight:	4.5 kg

Filter stages	0	LIMESCALE-NITRATE filter
	1	SEDIMENT-Filter 5 µm
	2	High-quality special activated CARBON GRANULATE filter
	3	MEMBRANE-filter
	4	ORIGINAL PI®-filter according to state-of-the-art scientific results

Filter replacement It is important to replace filters according to specified intervals. In order to guarantee high quality water for as long as possible, filter cartridges should be replaced at least once a year.

If you place a subscription order for your under sink system, you will automatically receive a new filter (on payment of the invoice) in time for the specified replacement interval. This way you will always have fresh filters for your system.

MAUNAWAI Under sink water system

This high-quality and low-maintenance compact system is installed under your kitchen sink and guarantees clean and tasty drinking water with a spring water structure that can wash through cells easily.

Parts supplied

- 1 Filter case, can also be wall-mounted
- 2 A ready-to-use assembled system
- 3 3-way valve 3/8in. (version A)
- 4 Fitting with internal screw thread for connection with 3/8 in. angle valve or with enclosed 3-way valve (version B)
- 5 ca. 2m 1/4 in. flexible plastic conduit (food safe)
- 6 1 installation wrench

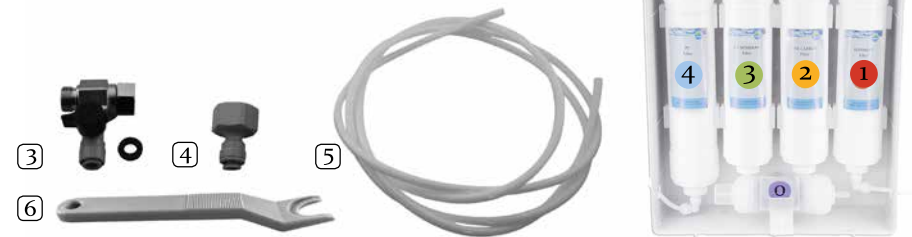

Additional requirements: 1 Tap

chromed drain cock or 3-way tap

Requirements for Connection

- The following requirements must be met:
- available water connection with 3/8 in. angle valve
Version A: occupied connection to sink tap;
Version B: free connection (see water connection – images at bottom left and back)
 - an additional stamped opening in the sink for assembly of tap, however not necessary if you have chosen the 3-way tap

INSTALLATION GUIDE

Preparation

Find a suitable space underneath the sink for your filter case, either standing upright or mounted to the wall. Remember that you will have to replace the cartridges regularly, so they should be easily accessible.

Water connection



Version A:
Assemble the enclosed 3-way valve between the angle valve and the pre-assembled sink tap.



Version B:
You do not need the enclosed 3-way valve. Screw the fitting to the angle valve.

Setting up the filter case

Press both buttons at the sides simultaneously and remove the lid from the case, then place it under the sink or attach it to the wall or the sides with 2 screws.

The filter system is already pre-assembled. Make sure that the arrow on the filter cartridges is showing in direction of the water flow.

Water supply – **ENTRANCE**
via filter cartridge 1, the sediment filter (or the “o” cartridge if you have 5 cartridges)

Water discharge – **EXIT**
via filter cartridge 4, the PI®-filter

In order to mount the tap next to the pre-existing tap, it is necessary to stamp an additional opening in the sink. Then mount the tap like any other regular tap for a sink.

If you have chosen the 3-way tap, then you only need to replace the old one. The third connection point for the MAUNAWAI® water system remains unused for the time being.

MAUNAWAI® tubes have a diameter of 1/4in. Measure the distance between the angle valve and the fitted tap and the filter case. Please measure generously, as the tubes should slightly sag. Cut the tubes with a sharp knife diagonally to the direction in which the tube shows.

Attention: Do not use a saw or crimping pliers!

Fitting the tap

Fitting the tubes

Connections
Water supply/
Water discharge

Water supply:
 connect the ENTRANCE with the 2-way valve.

Water discharge:
 next connect the outlet EXIT with the tap or the free connection on the 3-way tap.

Connecting
pipes and fittings

These connections can be severed at any time. The connectors guarantee a permanently safe and airtight connection between the tube and the fastener. This patented system holds the tube safely without indenting it or decreasing the flow of water.

Assembly



Cut the front end of the tube vertically before plugging it in. The outer surface of the plugged in tube should be clean and scratch-free. Once unplugged, the tube must be cut again.

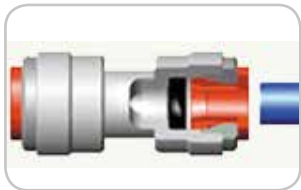

The connection will hold before it becomes airtight: Even if you have the feeling that the insert is blocked before the tube reaches the end, push the tube as far as it goes right to the end.

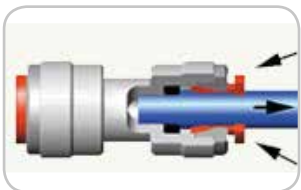

Check the connection by pulling: Check whether the tube is plugged in safely which can be easily done by either giving it a tug or by using the enclosed wrench to push it away from the fitting at the back of the hanger.

Now connect the inlet pipe with the mounted fitting on the 3-way valve (Version A) or the angle valve (Version B) as well as with the ENTRANCE.



Fitting



3-way valve
 (Version A)

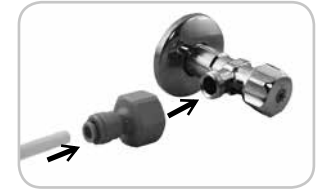

angle valve
 (Version B)

Water discharge

Now connect the drain pipe with the outlet EXIT and the other end with your tap (according to the respective description).

Open the tap and then slowly the stopcock on the 3-way valve/angle valve. Let water run through the system for 5 min.

Once the air has escaped automatically out of the filter system, your own "house spring" will provide you with water.

Connecting
drain cock

Start

Disconnecting connections

A tube can be disconnected by pushing the holding system back and pulling the tube out of the fitting. The fittings are re-usable.

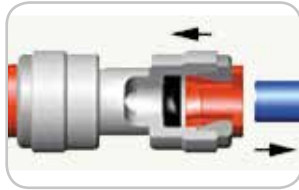

replacement of the system

1. Close the valve.
2. Open the tap to release the water pressure.
3. Disconnect the under sink system's fittings at both ends and remove (ENTRANCE, EXIT) the system from its hanger.
4. Plug the supplied end pieces (s. image) into both inlets and outlets.
5. Connect the new system at both sides.
6. Open the valve carefully and check whether it is airtight.
7. Let water flow through the system for 5 min.



We hope you will enjoy your MAUNAWAI® water system!

...and don't forget to drink enough water every day!

Revitalise with every sip of MAUNAWAI® water!

Your MAUNAWAI®-TEAM

Do you have any other questions?
Send us an e-mail: info@maunawai.com
or give us a call.

CONTACT

Green d'Or GmbH
Adolf-Damaschke-Straße 69 – 70
D-14542 Werder (Havel)
E-Mail: info@maunawai.com
Webseite: www.maunawai.com
Serviceline: +49 3327 570 89 26
Fax: +49 3327 570 89 30

Our authorised retailers will gladly provide any information you need regarding water.

**MAUNAWAI® Under sink system
with drain cock
(Versions A and B)**

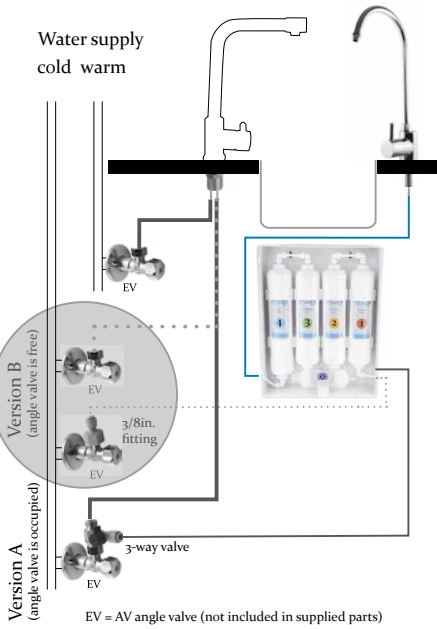

**MAUNAWAI® Under sink system
with 3-way tap
(Versions A and B)**

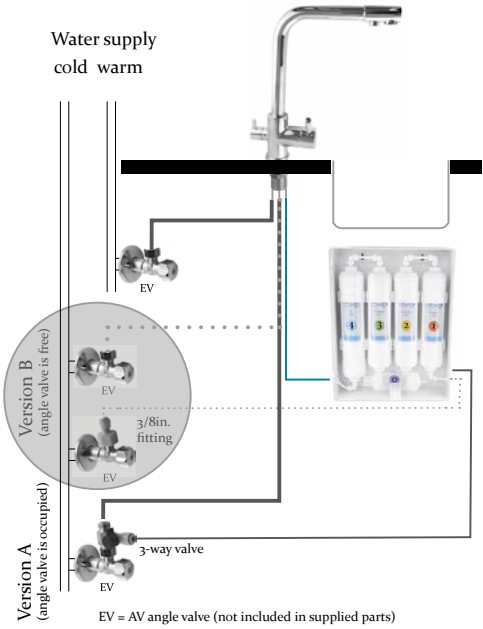

B-U-08-03-en-00
Fotos: © djama; Donnerbold-Fotolia.com/ryastek;laflor-istockphoto.com

© Green d'Or GmbH
Adolf-Damaschke-Straße 69-70 · D-14542 Werder (Havel)
Telefon +49 3327 5708926 · info@maunawai.com